

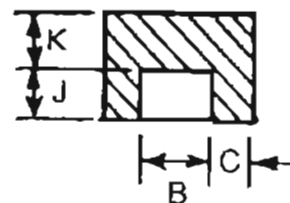

SOCKET-WELDING FITTINGS

ASME B16.11-1996 (REVISION OF ASME B16.11-1991)

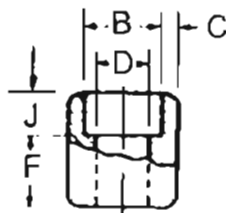
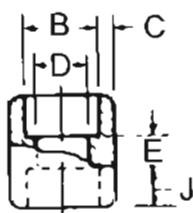

COUPLING

HALF COUPLING

CAP

Dimensions in Millimeters.

Center to Bottom of Socket-A						Laying Lengths		Tolerances \pm			End Wall Thickness K Min.			Nom. Pipe Size	DN
90° Elbows Tees, Crosses			45° Elbows			Couplings E	Half Couplings F	A	E	F	Class Designation				
3000	6000	9000	3000	6000	9000						3000	6000	9000		
11.0	11.0		8.0	8.0		6.5	16.0	1.0	1.5	1.0	4.8	6.4		1/8	6
11.0	13.5		8.0	8.0		6.5	16.0	1.0	1.5	1.0	4.8	6.4		1/4	8
13.5	15.5		8.0	11.0		6.5	17.5	1.5	3.0	1.5	4.8	6.4		3/8	10
15.5	19.0	25.5	11.0	12.5	15.5	9.5	22.5	1.5	3.0	1.5	6.4	7.9	11.2	1/2	15
19.0	22.5	28.5	13.0	14.0	19.0	9.5	24.0	1.5	3.0	1.5	6.4	7.9	12.7	3/4	20
22.5	27.0	32.0	14.0	17.5	20.5	12.5	28.5	2.0	4.0	2.0	9.6	11.2	14.2	1	25
27.0	32.0	35.0	17.5	20.5	22.5	12.5	30.0	2.0	4.0	2.0	9.6	11.2	14.2	1-1/4	32
32.0	38.0	38.0	20.5	25.5	25.5	12.5	32.0	2.0	4.0	2.0	11.2	12.7	15.7	1-1/2	40
38.0	41.0	54.0	25.5	28.5	28.5	19.0	41.0	2.0	4.0	2.0	12.7	15.7	19.0	2	50
41.0			28.5			19.0	43.0	2.5	5.0	2.5	15.7	19.0		2-1/2	65
57.0			32.0			19.0	44.5	2.5	5.0	2.5	19.0	22.4		3	80
66.5			41.0			19.0	48.0	2.5	5.0	2.5	22.4	28.4		4	100

NOTES:

(1) Average of Socket Wall Thickness around periphery shall be no less than listed values.

The minimum values are permitted in localized areas.

(2) Upper and lower values for each size are the respective maximum and minimum dimensions.

(3) DIMENSIONAL TOLERANCES: see page 17