

FireLock® Outlet-T

STYLE 922



The Style 922 Outlet-T provides a convenient method of incorporating ½, ¾, and 1"15, 20 and 25 mm outlets for directly connecting sprinklers, drop nipples, sprigs, gauges, drains and other outlet products. Available for 1¼ through 76.1 mm/32 to 76.1 mm piping systems, Style 922 outlets are UL/ULC Listed, LPCB and FM Approved for branch connections and VdS Approved for direct sprinkler connection only on wet and dry systems.

The locating collar engages into the hole prepared in the pipe. When tightened, the assembly compresses the gasket onto the OD of the pipe. The Style 922 Outlet-T is UL/FM rated up to 300 psi/2068 kPa and VdS rated up to 16 bar at the ambient temperatures typical for fire protection systems.

Style 922 is suitable for use on standard, lightwall, Schedule 5 and other specialty pipes.* Contact Victaulic for other optional coatings.

*Consult Section 10.01 for specific listings/approvals.



MATERIAL SPECIFICATIONS

Housing: Ductile iron conforming to ASTM A-536, grade 65-45-12. Ductile iron conforming to ASTM A-395, grade 65-45-15, is available upon special request.

Gasket:

- **Grade "E" EPDM - Type A**
(Violet color code). FireLock products have been Listed by Underwriters Laboratories Inc. and Approved by Factory Mutual Research for wet and dry (oil free air) sprinkler services up to the rated working pressure using the Grade "E" Type A Gasket System.

Bolts/Nuts: Heat-treated plated carbon steel, trackhead meeting the physical and chemical requirements of ASTM A-449 and physical requirements of ASTM A-183.

Housing Coating:

- Orange enamel (North America, Latin America, Asia Pacific)
- Red enamel (Europe)

JOB/OWNER

System No. _____
Location _____

CONTRACTOR

Submitted By _____
Date _____

ENGINEER

Spec Sect _____ Para _____
Approved _____
Date _____

FireLock® Outlet-T

STYLE 922

DIMENSIONS

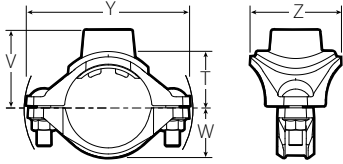

Nominal Size inches/mm		Hole Diameter	Dimensions – inches/millimeters					Approx. Weight Each	
Run X Branch FPT†		+0.06/+1.5 -0.00/-0.0	T*	V	W	Y	Z	lbs/kg	
1 ¼ 32	X	½ 15	1 ¾ 30.2	1.30 33.0	1.83 46.5	1.10 27.9	3.87 98.3	2.56 65.0	1.0 0.45
		¾ 20	1 ¾ 30.2	1.28 32.5	1.83 46.5	1.10 27.9	3.87 98.3	2.56 65.0	1.1 0.50
		1 25	1 ¾ 30.2	1.52 38.6	2.18 55.4	1.10 27.9	3.87 98.3	2.56 65.0	1.2 0.54
1 ½ 40	X	½ 15	1 ¾ 30.2	1.42 36.1	1.95 49.5	1.22 31.0	4.08 103.6	2.56 65.0	1.2 0.54
		¾ 20	1 ¾ 30.2	1.40 35.6	1.95 49.5	1.22 31.0	4.08 103.6	2.56 65.0	1.2 0.54
		1 25	1 ¾ 30.2	1.64 41.7	2.30 58.4	1.22 31.0	4.08 103.6	2.56 65.0	1.3 0.59
2 50	X	½ 15	1 ¾ 30.2	1.66 42.2	2.19 55.6	1.46 37.1	4.60 116.8	2.56 65.0	1.3 0.59
		¾ 20	1 ¾ 30.2	1.64 41.7	2.19 55.6	1.46 37.1	4.60 116.8	2.56 65.0	1.4 0.64
		1 25	1 ¾ 30.2	1.88 47.8	2.54 64.5	1.46 37.1	4.60 116.8	2.56 65.0	1.5 0.68
2 ½ 65	X	½ 15	1 ¾ 30.2	1.91 48.5	2.44 62.0	1.71 43.4	5.40 137.2	2.56 65.0	1.6 0.73
		¾ 20	1 ¾ 30.2	1.89 48.0	2.44 62.0	1.71 43.4	5.40 137.2	2.56 65.0	1.6 0.73
		1 25	1 ¾ 30.2	2.13 54.1	2.79 70.9	1.71 43.4	5.40 137.2	2.56 65.0	1.6 0.73
76.1 mm	X	½ 15	1 ¾ 30.2	1.91 48.5	2.44 62.0	1.71 43.4	5.50 139.7	2.56 65.0	1.6 0.73
		¾ 20	1 ¾ 30.2	1.89 48.0	2.44 62.0	1.71 43.4	5.50 139.7	2.56 65.0	1.6 0.73
		1 25	1 ¾ 30.2	2.13 54.1	2.79 70.9	1.71 43.4	5.50 139.7	2.56 65.0	1.7 0.80

† Victaulic female threaded products are designed to accommodate standard NPT or BSPT (optional) male pipe threads only. Use of male threaded products with special features, such as probes, dry pendent sprinklers, etc., should be verified as suitable for use with this Victaulic product. Failure to verify suitability in advance may result in assembly problems or leakage.

*Center of run to engaged pipe end for NPT threads (dimensions are approximate).

FireLock® Outlet-T

STYLE 922

PERFORMANCE

Run Size x Outlet Size			Equivalent Length of 1 inch Schedule 40 Steel Pipe (per UL 213, Section 16) (C=120)*, FT
Inches/mm			Feet/meters
1¼ 32	X	1 25	8.5 2.6
1½ 40	X	1 25	8.5 2.6
2 50	X	1 25	8.5 2.6
2½ 65	X	1 25	8.5 2.6
76.1 mm	X	1 25	8.5 2.6

* Hazen-Williams coefficient of friction is 120