

When ordering, please quote Part No. for required thread size and surface finish.

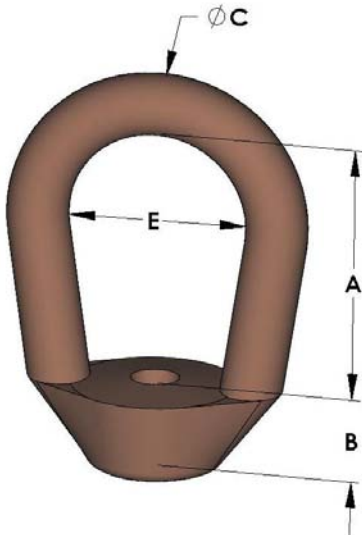

Material
Forged Carbon Steel
Surface Finish
Hot Dipped Galvanised or Plain

General Notes

- Supplied with a Right Hand Thread.
- Hot Dipped Galvanised items tapped oversize for assembly with galvanised threaded rod.
- Please refer to page 3 for material standards and specifications.

Description	(A)	(B)	(C)	(E)	Maximum Load at 340°C	Item Weight	Part No.	
	mm	mm	mm	mm			Plain	HDG
M10 Forged Eye Nut	50	20	13	38	544	0.2	204001	204020
M12 Forged Eye Nut	50	20	13	38	998	0.3	204002	204021
M16 Forged Eye Nut	50	20	13	38	1,678	0.3	204003	204022
M20 Forged Eye Nut	64	28	19	47	2,495	0.8	204004	204023
M24 Forged Eye Nut	64	28	19	47	4,536	1.0	204005	204024
M30 Forged Eye Nut	84	35	26	62	7,257	1.6	204006	204025
M36 Forged Eye Nut	84	35	26	62	10,206	1.6	204007	204026
M42 Forged Eye Nut	154	62	38	98	13,834	7.9	204008	204027
M48 Forged Eye Nut	154	62	38	98	18,144	7.9	204009	204028
M56 Forged Eye Nut	155	64	38	102	21,772	8.0	204010	204029
M64 Forged Eye Nut	155	64	38	102	23,677	8.0	204011	204030
M72 Forged Eye Nut	155	64	38	102	23,677	8.0	204012	204031