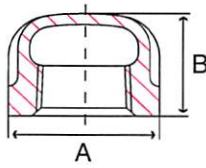
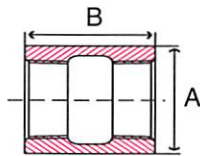

**Fig. S3014C & S3016C - Cap**



Size IN	Part Number		A IN	B IN	Packing		Weight LB
	304	316			Inner	Master	
1/8	S3014C 001	S3016C 001	0.53	0.47	300	1200	0.05
1/4	S3014C 002	S3016C 002	0.63	0.59	200	800	0.08
3/8	S3014C 003	S3016C 003	0.79	0.63	120	480	0.1
1/2	S3014C 004	S3016C 004	1.02	0.79	90	360	0.2
3/4	S3014C 006	S3016C 006	1.22	0.83	50	200	0.3
1	S3014C 010	S3016C 010	1.52	0.98	25	100	0.5
1-1/4	S3014C 012	S3016C 012	1.81	1.14	16	64	0.7
1-1/2	S3014C 014	S3016C 014	2.09	1.18	15	60	0.9
2	S3014C 020	S3016C 020	2.60	1.30	8	32	1.3
2-1/2	S3014C 024	S3016C 024	3.31	1.34	-	30	2.3
3	S3014C 030	S3016C 030	3.94	1.42	-	18	3.7
4	S3014C 040	S3016C 040	4.88	1.46	-	12	5.6

STANDARD 150#



**Fig. S3014CP & S3016CP - Full Coupling**

Size IN	Part Number		A IN	B IN	Packing		Weight LB
	304	316			Inner	Master	
1/8	S3014CP001	S3016CP001	0.55	0.77	200	800	0.03
1/4	S3014CP002	S3016CP002	0.71	0.94	120	480	0.1
3/8	S3014CP003	S3016CP003	0.83	0.98	100	400	0.1
1/2	S3014CP004	S3016CP004	1.02	1.26	60	240	0.3
3/4	S3014CP006	S3016CP006	1.22	1.38	36	144	0.4
1	S3014CP010	S3016CP010	1.50	1.65	18	72	0.7
1-1/4	S3014CP012	S3016CP012	1.89	1.85	12	48	1.1
1-1/2	S3014CP014	S3016CP014	2.13	1.85	12	48	1.5
2	S3014CP020	S3016CP020	2.60	1.97	4	16	2.3
2-1/2	S3014CP024	S3016CP024	3.23	2.52	-	10	2.6
3	S3014CP030	S3016CP030	3.74	2.91	-	6	3.2
4	S3014CP040	S3016CP040	4.78	3.15	-	4	5.9
6	S3014CP060	S3016CP060	6.75	5.40	-	1	13.4

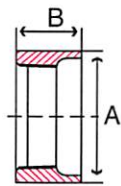

**Fig. S3014HC & S3016HC - Half Coupling**

Size IN	Part Number		A IN	B IN	Packing		Weight LB
	304	316			Inner	Master	
1/8	S3014HC001	S3016HC001	0.55	0.30	400	1600	0.0220
1/4	S3014HC002	S3016HC002	0.71	0.39	300	1200	0.03
3/8	S3014HC003	S3016HC003	0.83	0.45	200	800	0.05
1/2	S3014HC004	S3016HC004	1.02	0.57	120	480	0.08
3/4	S3014HC006	S3016HC006	1.22	0.67	70	280	0.1
1	S3014HC010	S3016HC010	1.50	0.79	40	160	0.2
1-1/4	S3014HC012	S3016HC012	1.89	0.87	24	96	0.3
1-1/2	S3014HC014	S3016HC014	2.13	0.85	20	80	0.4
2	S3014HC020	S3016HC020	2.60	1.18	10	40	0.5
2-1/2	S3014HC024	S3016HC024	3.23	1.26	6	24	1.0
3	S3014HC030	S3016HC030	3.74	1.50	-	12	1.2
4	S3014HC040	S3016HC040	4.76	1.50	-	12	2.3
6	S3014HC060	S3016HC060	6.75	1.75	-	1	3.6

Note: Non-MSS Fittings, Dimensions, Weights and Packing May Vary.