

Dimensional Documentation

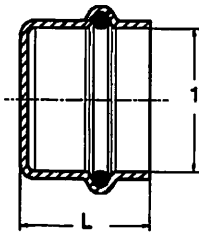

Cap P w/ EPDM Seal - Models 0156 / 4056



| Stock Code | | Size | L |
|------------|---------|------|------|
| S/S 304 | S/S 316 | 1 | (in) |
| 85355 | 80355 | ½" | 0.82 |
| 85360 | 80360 | ¾" | 1.04 |
| 85365 | 80365 | 1" | 1.06 |
| 85370 | 80370 | 1¼" | 1.20 |
| 85375 | 80375 | 1½" | 1.59 |
| 85380 | 80380 | 2" | 1.74 |

Cap P w/ FKM Seal - Model 6056

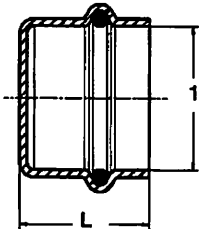

| Stock Code | | Size | L |
|------------|--|------|------|
| S/S 304 | | 1 | (in) |
| 85357 | | ½" | 0.82 |
| 85362 | | ¾" | 1.04 |
| 86367 | | 1" | 1.06 |
| 86372 | | 1¼" | 1.20 |
| 86377 | | 1½" | 1.59 |
| 86382 | | 2" | 1.74 |

Union P x P w/ EPDM Seal - Models 0160 / 4060

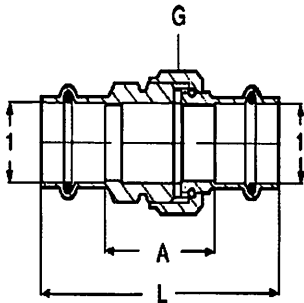

| Stock Code | | Size | A | L | G |
|------------|---------|------|------|------|-----|
| S/S 304 | S/S 316 | 1 | (in) | (in) | |
| 86005 | 81005 | ½" | 1.87 | 3.37 | ¾" |
| 86010 | 81010 | ¾" | 1.89 | 3.70 | 1" |
| 86015 | 81015 | 1" | 2.25 | 4.06 | 1¼" |
| 86020 | 81020 | 1¼" | 2.25 | 4.31 | 1½" |
| 86025 | 81025 | 1½" | 2.68 | 5.53 | 2" |
| 86030 | 81030 | 2" | 2.95 | 6.12 | 2½" |

Union P x P w/ FKM Seal - Model 6060

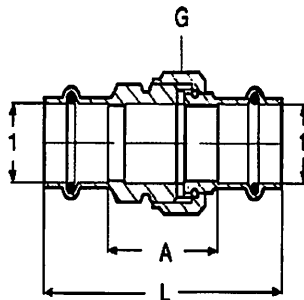

| Stock Code | | Size | A | L | G |
|------------|--|------|------|------|-----|
| S/S 304 | | 1 | (in) | (in) | |
| 86007 | | ½" | 1.87 | 3.37 | ¾" |
| 86012 | | ¾" | 1.89 | 3.70 | 1" |
| 86017 | | 1" | 2.25 | 4.06 | 1¼" |
| 86022 | | 1¼" | 2.25 | 4.31 | 1½" |
| 86027 | | 1½" | 2.68 | 5.53 | 2" |
| 86032 | | 2" | 2.95 | 6.12 | 2½" |